

BASE MOUNT HOLE
DRILLED 180° FROM GRIPPER



WALL-MOUNTED PONY WALL POST PARTITION
409.03 | .472 Single Section

These drawings have not been reviewed and approved by the architect and cannot ever be used for construction purposes. These drawings are for the exclusive use of Lumicor. Any use of these drawings by others will be at their own risk and lumicor will not be responsible for issues that may arise from their use.

© Lumicor 2019 — All Rights Reserved. For more information, visit www.lumicor.com or call 1.888.LUMICOR (888.586.4267)

Solution
409.03

7/30/20

Page 1 of 2

BILL OF MATERIALS

ITEM NUMBER	QUANTITY PER CONFIG	PART DESCRIPTION
1	1	CONCRETE ANCHOR
2	1	INTERNAL BASE MOUNT WITH [3] $\frac{5}{16}$ "-18 X $\frac{3}{8}$ " BUTTON SOCKET SET SCREW
3	6	$\frac{1}{2}$ " GRIPPER
4	6	$\frac{5}{16}$ "-18 X $\frac{5}{8}$ " STEEL STUD
5	6	WASHER
6	6	$\frac{1}{4}$ "-20 SET SCREW
7	6	CLEAR PVC TUBING
8	1	2.5" DIA FREE STANDING POST
9	1	POST CAP WITH GASKET

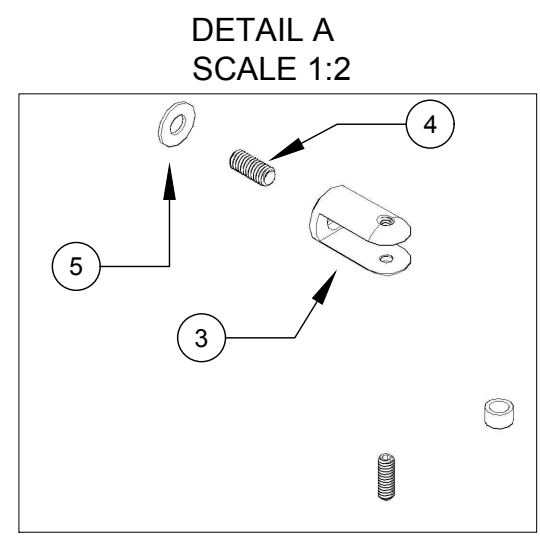
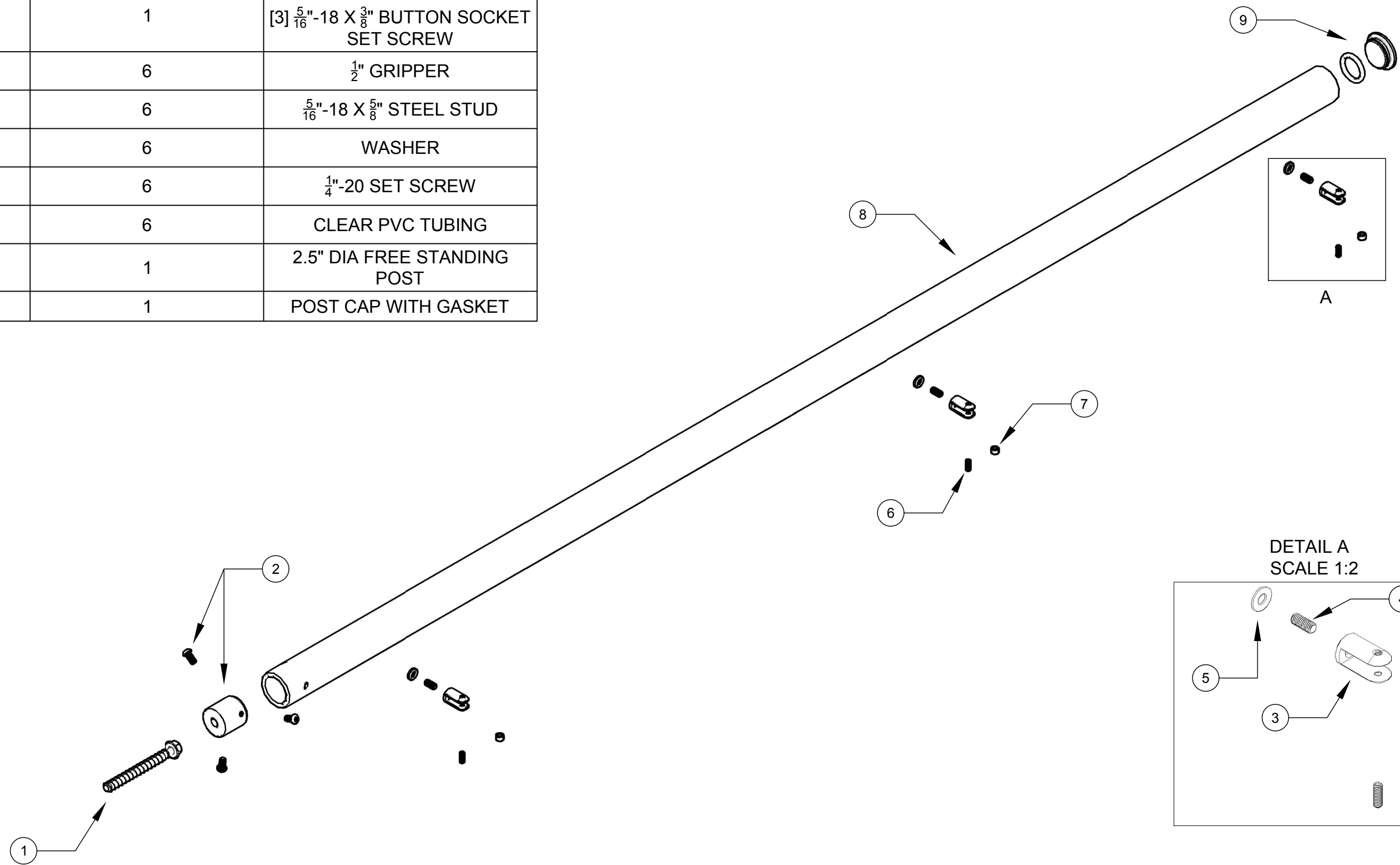

	WALL-MOUNTED PONY WALL POST PARTITION 409.03 .472 Single Section	Solution 409.03
	These drawings have not been reviewed and approved by the architect and cannot ever be used for construction purposes. These drawings are for the exclusive use of Lumicor. Any use of these drawings by others will be at their own risk and lumicor will not be responsible for issues that may arise from their use.	7/30/20
	© Lumicor 2019 — All Rights Reserved. For more information, visit www.lumicor.com or call 1.888.LUMICOR (888.586.4267)	Page 2 of 2